

Mixed operations word problems

Grade 5 Word Problems Worksheet

A multi-level parking lot has 6 levels and there are total of 1,327 parking spots.

1. There are 162 parking spots on the first level. The rest of the parking spots are distributed equally on the other 5 levels. How many parking spots are there on the top level?
2. On each level, there are 12 spots close to the 3 elevators reserved for drivers with disabilities. How many parking spots are reserved for drivers with disabilities altogether?
3. Other than the spots reserved for drivers with a disability, there are 285 parking spots for monthly rentals and the rest are for hourly parking. How many spots are there for hourly parking?

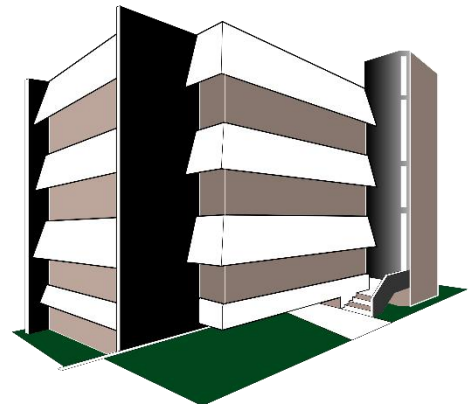

Answers

- $(1,327 - 162) \div 5 = 233$
There are 233 parking spots on the top level.
- $12 \times 6 = 72$
There are 72 parking spots reserved for drivers with disability.
- $1,327 - 72 - 285 = 970$
There are 970 spots available for hourly parking.
- $30 \times 5 \times 4 \times 12 = 7,200$
Jack pays \$7,200 for parking in a week.
- $1,327 - (816 - 91 + 135) = 467$
There are 467 parking spots left on Monday afternoon.
- $1327 (7x) = 27,867$
 $7x = 21$
 $x = 3$
The hourly rate is \$3.